

MFA0296

Blower for Blended O₂ & 100% Air safe

With its **patented motor cooling system fully independent** from the air inlet flow the turbine guarantees a **full homogeneous blend Air-Oxygen**.

The **MFA296** is specially designed for acceleration allowing up to **150 BPM** for **neonate applications**.



designed for high BPM applications

PERFORMANCES

ΔP max @24V		70 hPa	static pressure
Q max @24V		320 l/mn	freeflow
Typical w/p @30 l/mn		P = 10.7 (W)	@30 hPa
		P = 19.9 (W)	@60 hPa
LifeTime (L10)		> 40 000 hours*	
Type		Casing integration	

* LifeTime expectancy based on standard operating conditions

	Dynamic transient time*	< 97 ms	@3A max
		< 92 ms	@6A max
		< 86 ms	@10A max
<i>* from 5 to 60 hPa @30 l/mn</i>			
	Noise Level*	< 29 dBa	@10 hPa
		< 41 dBa	@50 hPa
		< 48 dBa	@100 hPa

* with Blower inlet @1m

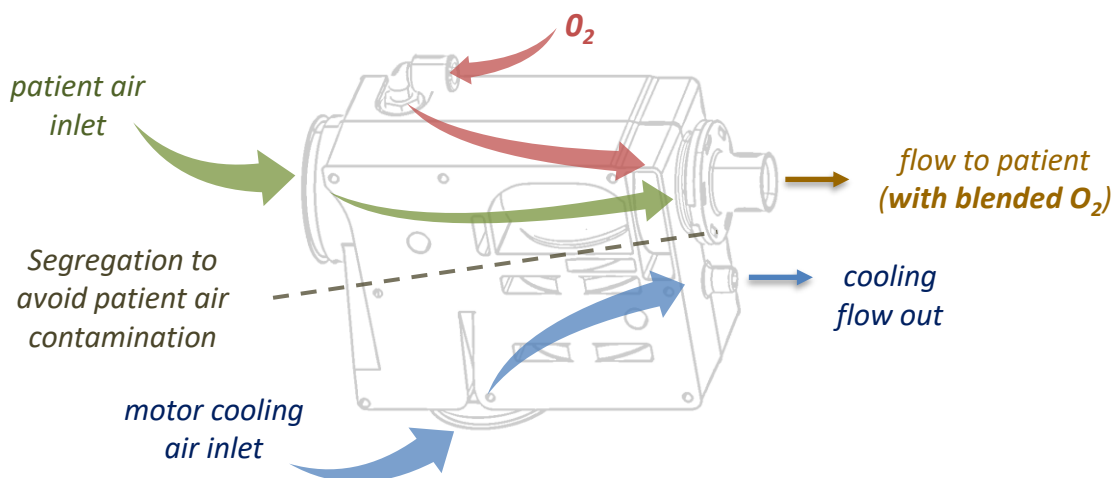

TECHNICAL DATA

Voltage supply	24 VDC (nom) 28 VDC (max)
Motor type	Brushless with Hall-effect sensors
Dimensions (casing)	130 x 100 x 61 mm (5.3 x 3.9 x 2.4 in)
Weight	0.45 kg (~ 1.00 Lb)
Integration	works in any position/orientation
Temperature	-20 to +50°C ambient
Humidity	0 to 95% RH non condensing
Atmospheric pressure	700 to 1100 hPa
Oxygen compatibility	100% O2 compatible

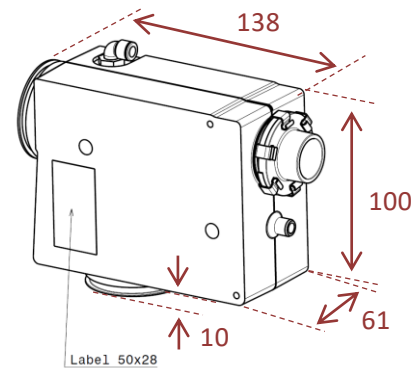

COMPRESSOR MAP

Static ΔP vs Airflow at Constant PWM and Motor Voltage

PWM = Pulse Width Modulation

MFA0296 Turbine

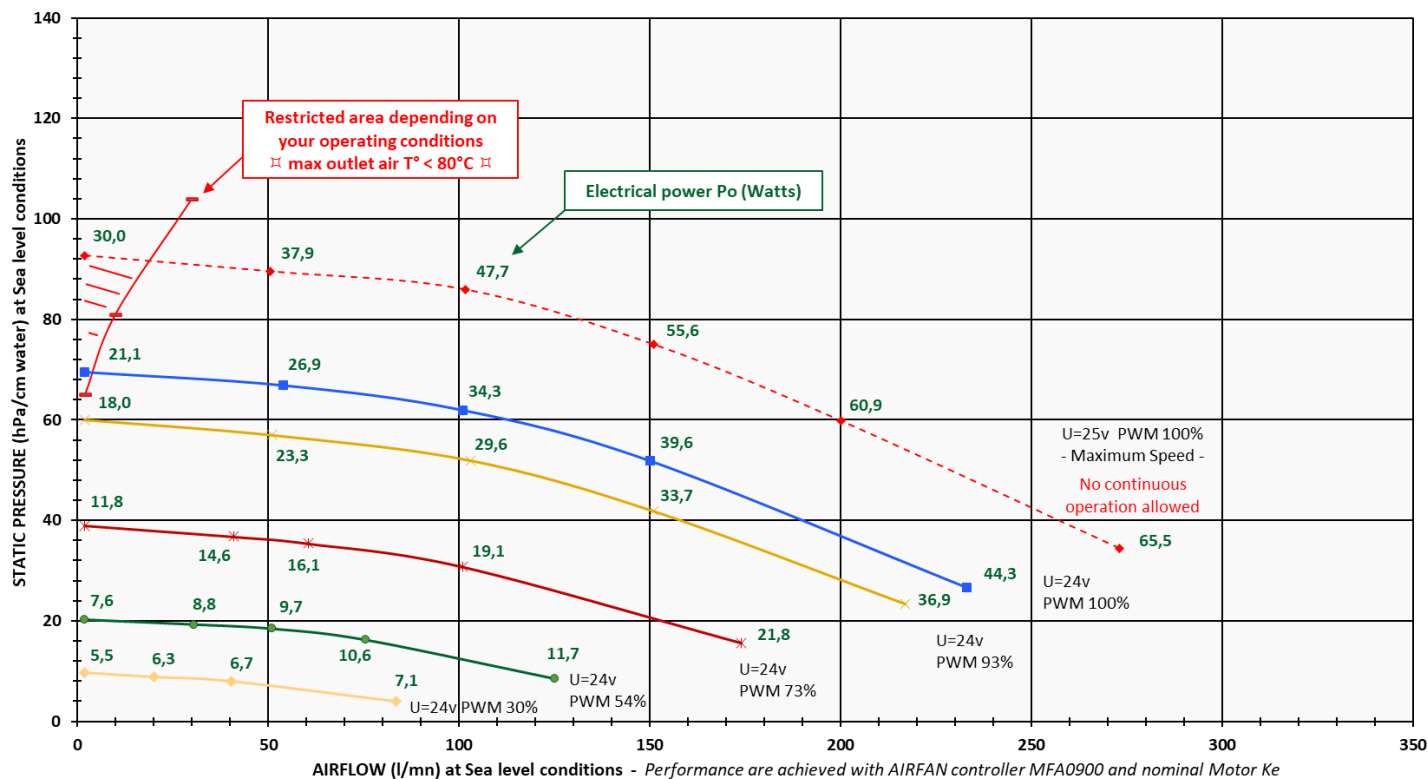

CUSTOMIZATION

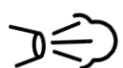

Outlet port

- Outlet port male or female connector (22 \varnothing ISO5356-1) or additional auxiliary ports



- O-ring for air inlet
- Custom label



- Inlet filter for motor cooling



- Wire Length 150 or custom



ASK FOR YOUR CUSTOMIZATION

